



118th Stated Meeting of the
Presbytery of Arkansas

Friday-Saturday, October 14-15, 2011
First Presbyterian Church
Conway, Arkansas

HOST CHURCH INFORMATION



First Presbyterian Church

2400 PRINCE STREET

CONWAY, ARKANSAS 72034

501-329-6483

8 September 2011

Dear Friend in Christ:

This summer friends from seminary days – more than 25 years ago – called and asked if they could spend the night with us on their way to New Mexico via Arkansas. I said we'd love to have them and that I looked forward to seeing them the next week. When I excitedly told my spousal unit, she reminded me of all the projects that had to be completed prior to their arrival: the office was half painted and needed to be finished, the commode by the guest room required repair, the flower beds had to be weeded and something had to be done about our teenaged son's room. It was a monumental task but we got it all done and had a marvelous visit. (Actually, I lie – we gave up on our son's room and simply nailed the door shut.) Thank God that company comes and we get all those much-needed chores done in expectation of their arrival.

Every church should host a meeting of presbytery now and then just to get all the chores done that we let slip by when only family is present. That's what we're doing in Conway at the present – getting ready for your arrival to the 118th stated meeting of Arkansas Presbytery on October 14-15. We are excited to have you come and are busily preparing for you. The floors are waxed and we've stocked all the restrooms with extra paper. The menu is prepared and the choir is getting tuned up. We're even trying to train our handful of grumpy parishioners to be hospitable while you are here.

You'll find a list of available restaurants for Friday dinner and directions to the church enclosed. Construction is to begin soon on Prince Street but it appears now that it won't begin until after the meeting. God is good. Our ingathering offering will be for Bethlehem House and more information is enclosed in your packet about what to bring. We'll have space for your disaster buckets if you arrive with them. If you need something else, let us know.

Again, we're excited for you to come and look forward to being with you as we worship and conduct the business of this Presbyterian expression of the community of faith. We'll leave the light on. (That reminds me: tell Property Committee to replace the burned out bulbs on the porch lights.)

Grace and peace and all good things,

Drew Travis, Pastor

First Presbyterian Church of Conway

Welcomes the Presbytery of Arkansas

2400 Prince Street
Conway, AR 72034

Phone: (501) 329-6483
Fax: (501) 450-7794
E-mail: office@firstpresconway.org
drew@fpccconway.org
Internet: www.fpccconway.org

Driving Directions*

From Interstate 40 Eastbound – Exit 124 (Wooster/Conway)

Exit and turn right at the end of the ramp. Proceed straight through the light, traveling up the hill onto Salem Road. After approximately 2 miles, turn left on Prince Street (first intersection with commercial businesses/banks). Travel approximately a 1/2 mile; church is on the left.

From Interstate 40 Westbound – Exit 127 (Oak Street/US-64)

Exit and turn left at the end of the exit ramp. Proceed on Oak Street through downtown Conway. Oak Street becomes Caldwell Street when you cross the railroad tracks. Turn right at the second light onto Donaghey Avenue. Travel one block and turn left onto Prince Street. Proceed on Prince Street (going half way through the roundabout). The church is on the right just past the high school (under construction).

From Hwy 64 (Vilonia)

At the Conway city limits, Hwy 64 becomes Oak Street. Proceed on Oak Street through downtown Conway. Oak Street becomes Caldwell Street when you cross the railroad tracks. Turn right at the second light onto Donaghey Avenue. Travel one block and turn left onto Prince Street. Proceed on Prince Street (going half way through the roundabout). The church is on the right just past the high school (under construction).

From Hwy 65 (Greenbrier)

At the Conway city limits, Hwy 65 becomes Skyline Drive. Proceed on Skyline toward downtown (you will pass half way through 2 roundabouts near Hendrix College). Skyline becomes Harkrider Street. Turn right on Oak Street (Walgreens will be on your right) and proceed through downtown. Oak Street becomes Caldwell Street when you cross the railroad tracks. Turn right at the second light onto Donaghey Avenue. Travel one block and turn left onto Prince Street. Proceed on Prince Street (going half way through the roundabout). The church is on the right just past the high school (under construction). (This route suggested due to street repairs on Donaghey between Tyler and Prince Streets.)

From Hwy 60 (Toad Suck)

At the Conway City limits, Hwy 60 becomes Prince Street. After the intersection of Prince and Salem (Regions Bank on right), continue on Prince Street approximately a 1/2 mile; church is on the left.

*Due to street repairs, we suggest that you avoid travel ing on Donaghey Ave. between Tyler and Prince Streets.

**Advice to the Wise
for Arriving at this Presbytery Meeting
on Time
especially
on Friday night, October 14.**

Please note and plan accordingly that there is significant street construction in Conway this fall which may slow down your travels once you arrive in town.

**(See the directions to the church page.)
Also the high school which is located next door to the church is hosting a football game that Friday night which attracts large, enthusiastic crowds.**

Please allow yourself plenty of time to get to the church for the workshops at 3 p.m. and for the gavel at 6:30 p.m. Friday night.

Of course, on Saturday morning when we resume at 8:30 a.m. we'll only deal with the construction.

Thank you and look forward to seeing you there!

First Presbyterian Church
2400 Prince Street
Conway, AR 72034
(501)329-6483

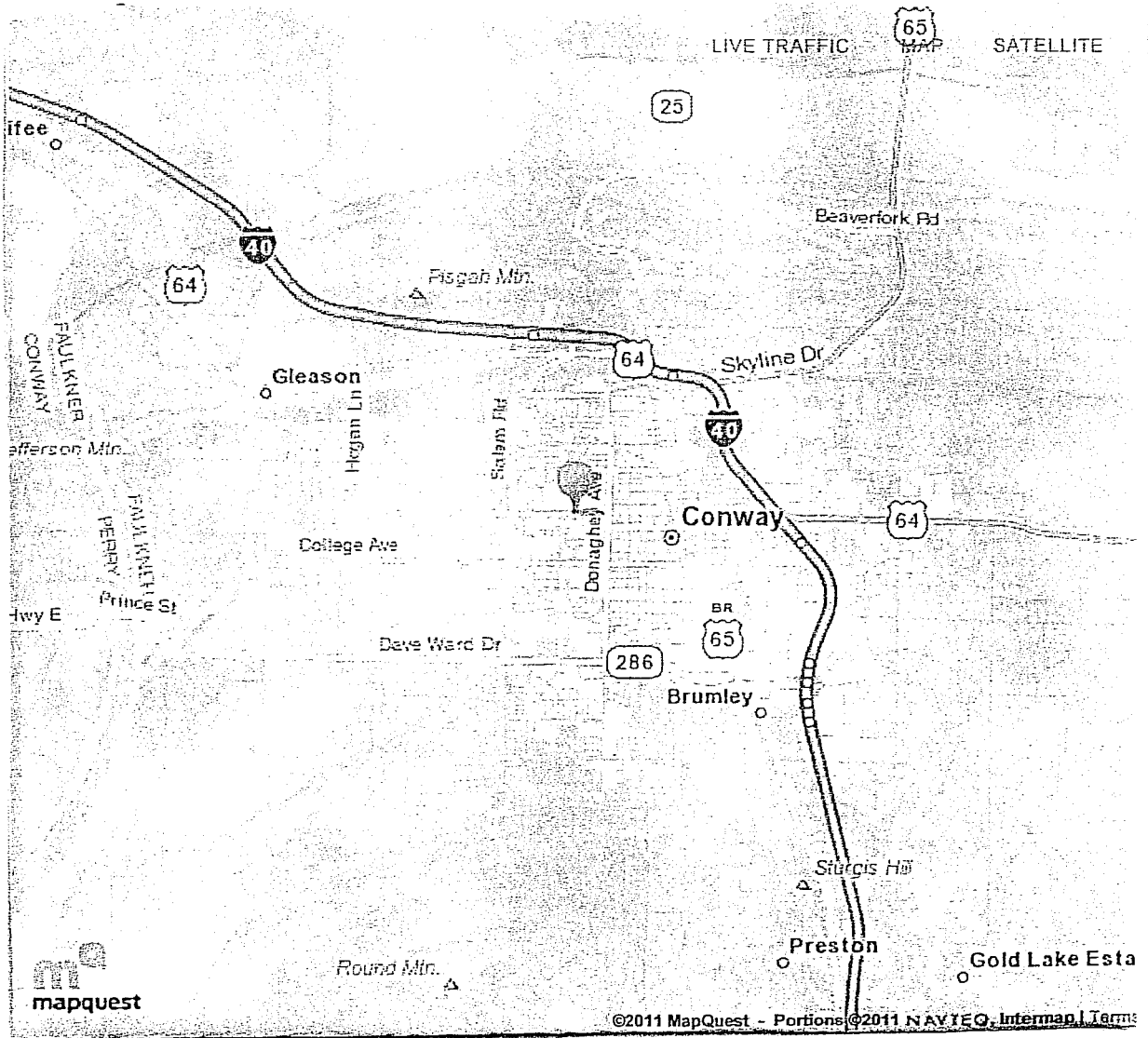
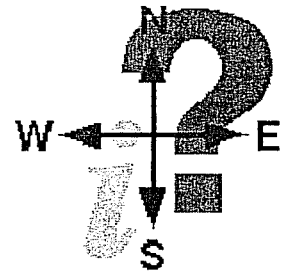

Parking for Presbytery of Arkansas Meeting, October 14 & 15, 2011

Due to construction at the Conway High School West campus (adjacent to the church property) and the Friday night football game, parking will be limited on Friday evening. Parking attendants with orange vests will be available at both entrances to the church parking lot to assist you with locating parking across the street or at the high school if the church lot is full. Parking is permitted in the high school lots after regular school hours. You can access the high school parking lot that is directly behind the church by taking the temporary driveway just east of the church entrance on Prince Street.

Please place this placard in the front windshield on the driver's side.

Fold Here



PRESBYTERY OF ARKANSAS MEETING OCTOBER 14 & 15, 2011

CONWAY HOTELS/MOTELS

For Conference Rate (CR), please reference "1st Presbyterian Church Conway"
Lower rates may be available through hotel discounters or other discount programs

| | | |
|------------------------------------|---|--|
| America's Best Value Inn & Suites | 815 East Oak Street 501-329-8392 www.americasbestvalueinn.com | Singles and Doubles \$45 (CR) Continental breakfast included |
| Best Western | 816 East Oak Street 501-329-9855 www.bestwestern.com | Singles and Doubles \$60.29 (CR) |
| Candlewood Suites | 2360 Sanders Street 501-329-8551 www.candlewoodsuites.com | Singles and Doubles \$69 (CR) |
| Comfort Suites | 705 Museum Road 501-329-8548 www.conwayonline.com | Singles and Doubles \$90 (CR) Full breakfast included |
| Country Inn and Suites | 750 Amity Road 501-932-0500 www.countryinns.com/conwayar | Singles and Doubles \$70 (CR) Full breakfast included |
| Days Inn | 1002 E Oak Street 501-450-7575 www.daysinn.com | Singles and Doubles \$60 (CR) Continental breakfast included |
| Fairfield Inn & Suites by Marriott | 2260 Sanders Road 501-505-8034 www.marriott.com/litcw | Singles and Doubles \$99 (CR) Kings or Suites (limited availability) Full breakfast included |
| Hampton Inn | 810 Museum Road 501-329-8999 www.hamptoninn.com | Singles and Doubles \$88.20 (same as AAA/AARP) |
| Hilton Garden Inn | 805 Amity Road 501-329-1444 www.conway.stayhgi.com | Singles and Doubles \$89 (CR) |
| Holiday Inn Express Hotel & Suites | 2370 Sanders Street 501-450-9112 www.conwayonline.com | Singles and Doubles \$89 (CR) Continental breakfast included |
| Howard Johnson | 1090 Skyline Drive 501-329-2961 www.howardjohnson.com | Singles and Doubles \$58.50 (CR) |
| Microtel Inn & Suites | 2475 Sanders Street 501-327-0898 www.microtelinn.com/hotel/30983 | Singles and Doubles \$60 (CR) Full breakfast included |
| Quality Inn | 150 Hwy 65 N 501-329-0300 www.conwayonline.com | Singles and Doubles \$55 (CR) Full breakfast included |
| Super 8 | 2430 Sanders Road 501-505-8880 www.super8.com | Singles and Doubles \$54 (CR) Hot & cold continental breakfast |

Conway Restaurant Guide

Prince/Salem Area

Casa Marachi

2225 Prince

Sonic Drive In

2710 Prince

Los Amigos

2850 Prince

Quizno's

2850 Prince

Taco Bell

2915 Prince

McDonald's

705 Salem

Moe's Southwest Grill

625 Salem

Slim Chickens

550 Salem

Pizza Hut

985 Carson Cove

Cactus Jack's

755 Club Lane

Downtown

Michelangelo's

1117 Oak

Mike's Place (Cajun)

808 Front

Bob's Grill

1112 Oak

Old Chicago Pizza

1010 Main

U.S. Pizza

710 Front

Blackwood's Grill (Greek)

803 Harkrider

(parking off Main St.)

South Donaghey

Stoby's

805 S. Donaghey

Smokehouse BBQ

505 S. Donaghey

Near Hotels

Cracker Barrel

201 Skyline Dr. (AR 65)

Marketplace Grill

600 Skyline Dr. (AR 65)

Colton's Steakhouse

120 E. Oak

Logan's Roadhouse

410 Elsinger

Mulan's (Chinese)

790 Elsinger

Arby's

810 Elsinger

Chick-fil-A

1115 E. Oak

Chili's

1111 E. Oak

T.G. I. F.

1105 E. Oak

Golden Corral (Buffet)

814 E. Oak

Burger King

905 Skyline Dr. (AR 65)

McAlister's Deli

2465 Sanders Rd.

Starbuck's

1035 Skyline Dr. (AR 65)

IHOP

1161 Old Morrilton Hwy

David's Burgers

1100 Skyline Dr. (AR 65)

Ruby Tuesday's

2400 Sanders Rd.

Outback Steakhouse

2310 Sanders Rd.

This is an abbreviated list of dining opportunities in Conway, focusing on establishments near FPC-Conway and hotels. For more information on dining in Conway visit www.goconway.com/restaurants

MEAL/CHILD CARE REGISTRATION FORM
PRESBYTERY OF ARKANSAS MEETING, OCTOBER 14-15, 2011

First Presbyterian Church of Conway

2400 Prince Street, Conway, AR 72034

PLEASE RESPOND BY FRIDAY, OCTOBER 7TH

1. By faxing form to 501- 450 -7794
2. By sending copy via e-mail to office@firstpresconway.org
3. By mailing form to the address above

SATURDAY LUNCHEON RESERVATION, OCTOBER 15

Number of reservations _____ (Deli Sandwich, Chips, Fruit, Dessert, Drink)

Number of reservations _____ (Vegetarian & Gluten Free – Fruit/Salad Plate, Dessert, Drink)

Total enclosed \$ _____ Lunch - \$8 per person; please make checks payable to **FPC Conway**

Tickets will be available for pick up at the registration desk during registration and before lunch.

Church Representative: _____

Address/Phone: _____

Name: _____ Name: _____

Name: _____ Name: _____

Name: _____ Name: _____

Signed: _____ (Church Representative)

CHILD CARE REGISTRATION FORM – October 14 – 15, 2011

Parent's Name (s): _____ Phone: _____ Cell: _____

Church: _____

Child's Name: _____ Age: ____ Child's Name: _____ Age: ____

_____ Fri. 2:30 – 5:00 pm _____ Fri. 5:30 – 9:00 pm* _____ Sat. 8:00 am – 3:30 pm*

*until end of the session

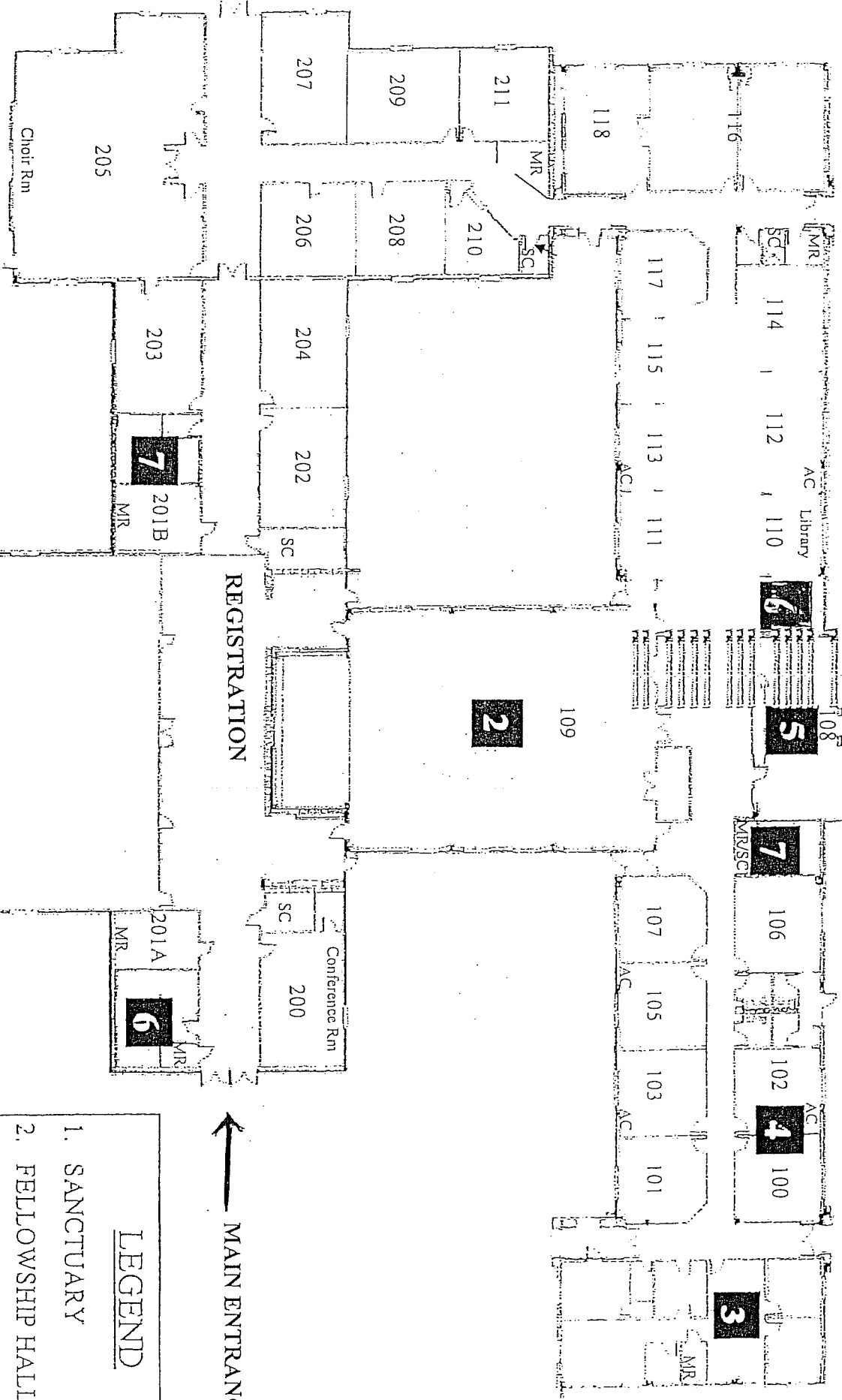

← MAIN ENTRANCE

LEGEND

1. SANCTUARY
2. FELLOWSHIP HALL
3. CHURCH OFFICE
4. NURSERY
5. KITCHEN
6. WOMEN'S RESTROOM
7. MEN'S RESTROOM

OTHER ROOMS IN USE ON FRIDAY

- 203, Committee on Ministry, 11 a.m.
- 200, Orientation of New Professionals
- 114, Childcare Friday only
- Narthex, Registration Friday and Saturday
- 116, Hunger Workshop, 3 p.m.
- 207, Feasting on the Word, 3 p.m.
- Sanctuary, Healing and Wholeness Service, 3 p.m.
- 202, Caring for Family Members, 3 p.m.
- 112, Committee on Clusters, 4 p.m.